

Tightening Torques in kpm

Hex. bolts for shift housing and governor housing on centrifugal governor

0.8

Disassembly

1 Replace oil sealing rings (5) as required by disconnecting and removing oil sealing rings (Fig. 1).

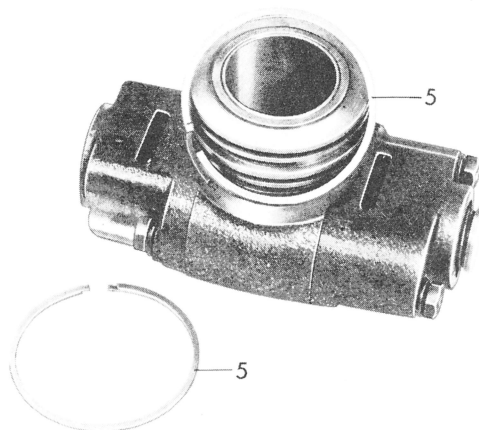

Fig. 1

5 Oil sealing rings

2 Unscrew hex. bolts (4) (Fig. 2).

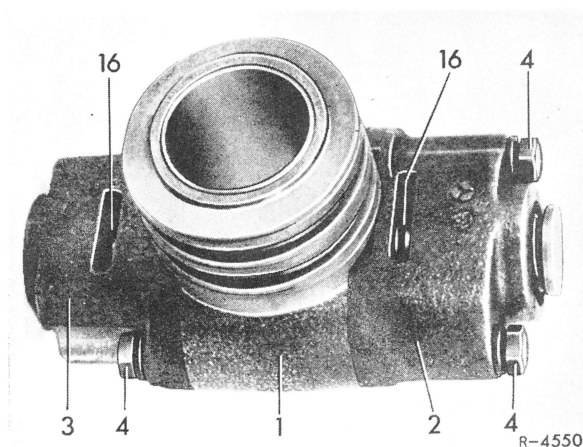

Fig. 2

1 Flange
2 Governor housing
3 Shift housing

4 Hex. bolts
6 Oil outlet slots

3 Remove shift housing (3) and governor housing (2) from flange (1).

4 Remove lock washer (6), compression spring (7), and shift valve (8) (Fig. 3).

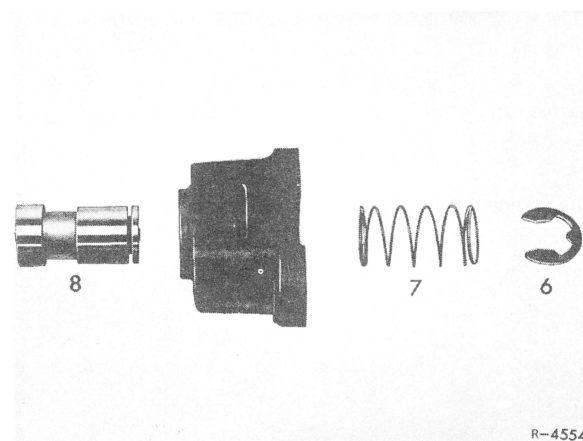

Fig. 3

6 Lock washer
7 Compression spring

8 Shift valve

5 Remove spring plate (9), centrifugal weight (10) and weak compression spring (11) in upward direction (Fig. 4).

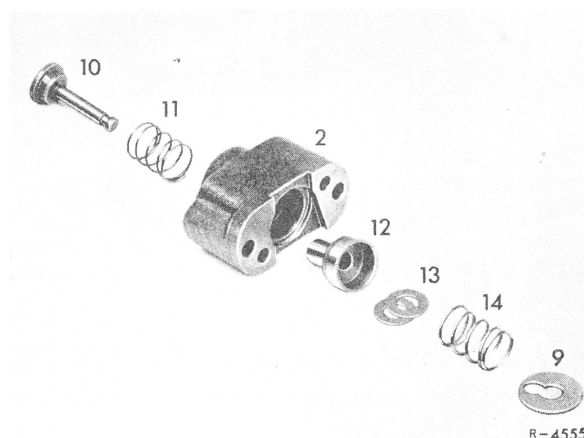

Fig. 4

2 Governor housing
9 Spring plate
10 Centrifugal weight
11 Compression spring

12 Control valve
13 Compensating washers
14 Compression spring

27.2 Disassembly and Assembly of Centrifugal Governor

6 Remove compression spring (14) with compensating washers (13) and control valve (12) in downward direction.

Assembly

Caution! Clean all parts well in cleaning gasoline. Check shift valve (8) (Fig. 3) and control valve (12) (Fig. 4) for damage and easy sliding in their bores.

7 Insert control valve (12) into governor housing (2).

8 Introduce centrifugal weight (10) with weak compression spring (11) into control valve (12). Push down on control valve, insert compensating washers (13) with compression spring (14) into control valve (Fig. 4).

Note: Do not change number of compensating washers.

9 Attach spring plate (9), watching out for correct seat (Fig. 5).

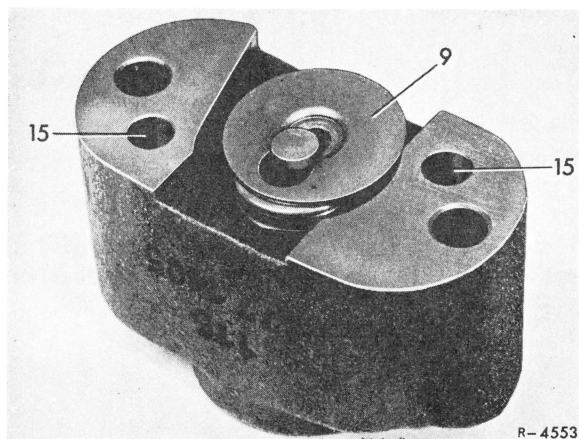

Fig. 5

9 Spring plate
15 Oil ducts

10 Insert shift valve (8) with compression spring (7) and push on lock washer (6) (Fig. 3).

Note: When pushing on lock washer make sure that the spring is not distorted in groove of lock washer.

11 Position shift housing (3) on flange (1) in such a manner that the oil outlet slots (16) are facing the oil seal rings (Fig. 2) and the oil ducts (15) are in agreement (Fig. 6).

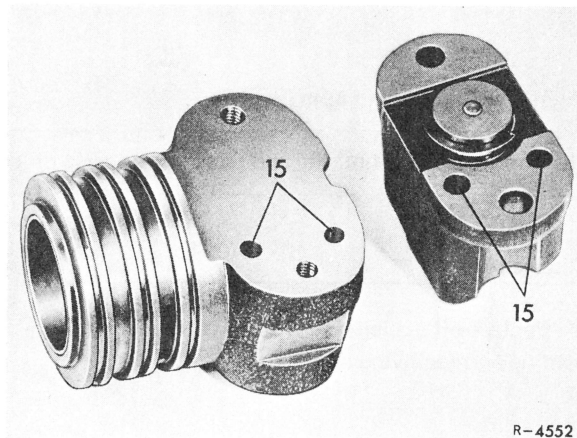

Fig. 6

15 Oil ducts

12 Insert strainer (17) into seat provided in oil duct (Fig. 7) and mount governor housing (2) with the oil outlet slots (16) facing the oil sealing rings (Fig. 2).

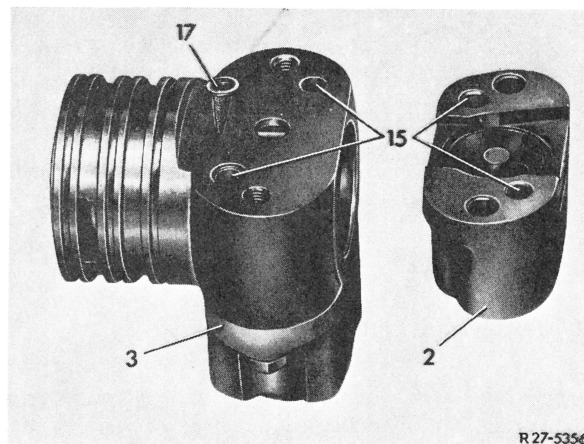

Fig. 7

2 Governor housing
3 Shift housing
15 Oil ducts
17 Strainer

13 Tighten hex. bolts (4) to 0.8 kpm (Fig. 2).

14 Replace oil sealing rings (5), if removed, by inserting into grooves and attaching as required (Fig. 1).

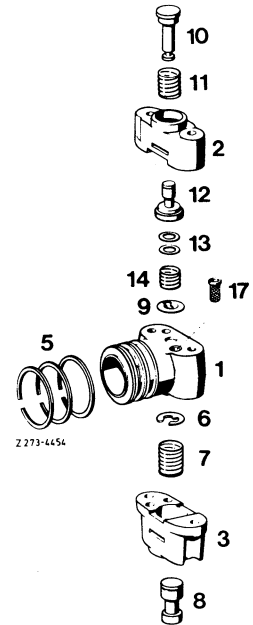

Fig. 8

- | | | |
|---------------------|-----------------------|-------------------------|
| 1 Flange | 7 Compression spring | 12 Control valve |
| 2 Governor housing | 9 Spring plate | 13 Compensating washers |
| 3 Shift housing | 10 Centrifugal weight | 14 Compression spring |
| 5 Oil sealing rings | 11 Compression spring | 17 Strainer |
| 6 Lock washer | | |